



Installation Instructions

Radio, Alarm

Version 4.0

Page 1 of 6

May 2009

Accessory
Development

These installation instructions supersede all previous versions

SUBJECT

X3 ALARM RETROFIT KIT P/N 65 73 0 420 696

MODEL

X3 (E83): Select Vehicle Production 08/2006 – 02/2009*

* Vehicle must have optional alarm pre-wiring (SA5GA), which is 100% for US X3 vehicles.

SUGGESTED INSTALLATION TIME: 1.0 HOURS**

Total installation time may vary depending on vehicle options and equipment.

** Suggested installation time includes re-coding of the vehicle only for this retrofit kit. This time is based on a vehicle that is at the current software level and does not require any updates.

Please refer to SI B09 05 01 for latest BMW approved Retrofit coding procedures.

The instructions below are developed for BMW vehicles and are not to be compared to any other existing instructions for vehicles other than BMW. No methods other than those specified in this document are to be used for installation in BMW vehicles. Left and right are determined from the driver's seat.

Carefully read all instructions and supplements before proceeding with the installation. Reference should be made to TIS for instructions dealing with a stock part of the vehicle but not stated in detail in these instructions.

The instructions were complete and up to date at time of publication; however, changes to the vehicle or installation may have occurred. Please report any problems or changes noted with the installation to BMW Technical Hotline, along with VIN, date of manufacture and as much detail as possible.

★ ★ DO IT RIGHT THE FIRST TIME, ON TIME, EVERY TIME ★ ★

PARTS INFORMATION**Contents of Kit – P/N 65 73 0 420 696**

Description	Qty	BMW Part Number
M6 hex bolt w/washer	1	07 11 9 903 844
Siren with tilt sensor	1	65 75 6 970 942
Bracket (for siren)	1	65 75 3 428 380
M6 hex nut w/lock washer	1	07 12 9 904 008
Prestol cage clip M6	1	32 41 1 095 443
Interior ultrasonic module	1	65 75 3 403 208

Alarm Siren-Tilt-Sensor Installation

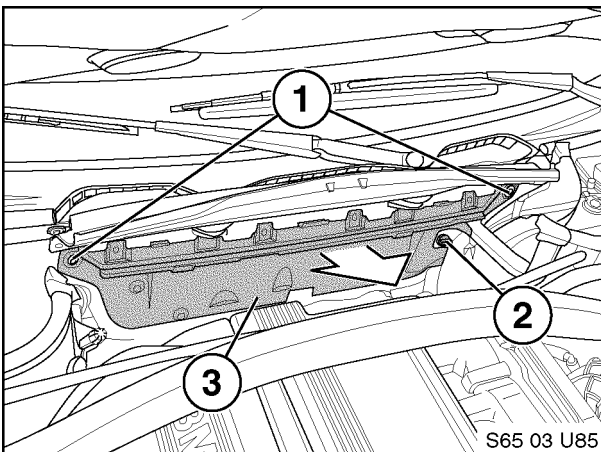
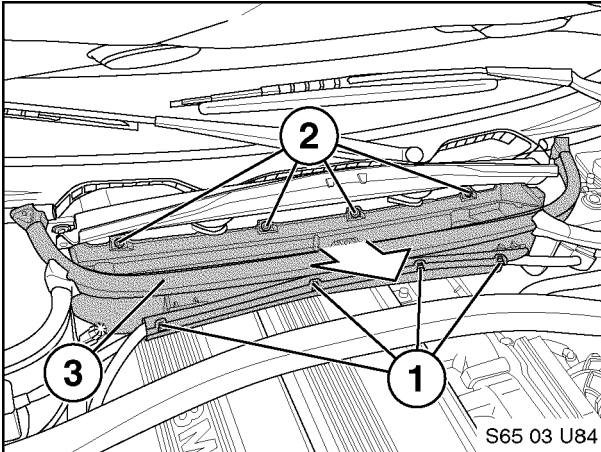
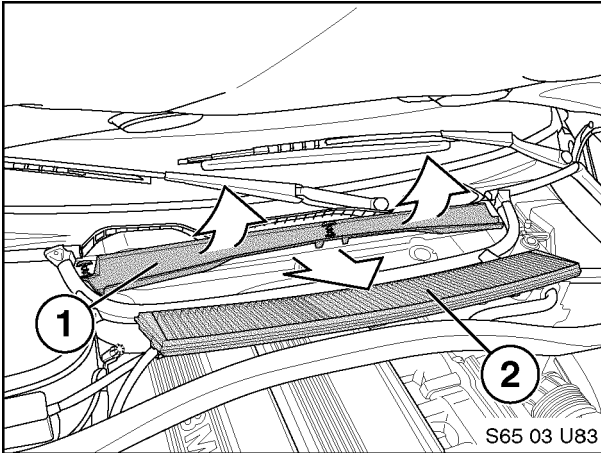
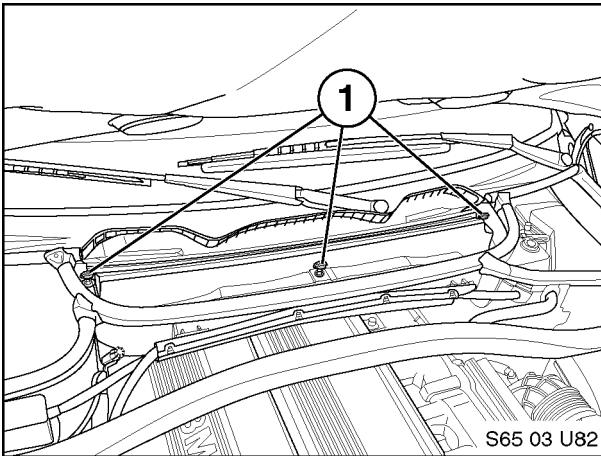

Disconnect negative battery terminal before proceeding with this installation.

1. Release (1/4 turn) the three spring loaded fasteners (1).
2. Lift up on grill cover (1) and remove air collector (2) as shown.
3. Carefully unclip the four outer retainers (1) to remove wire harness channel cover.
4. Remove wire harness from channel.
5. Loosen the four 30 Torx® head captive bolts (2) and remove microfilter housing (3).
6. Loosen the two 30 Torx® head captive bolts (1) on rearward panel (3).
7. Release (1/4 turn) plastic retainer (2) and remove from rearward panel (3).
8. Remove rearward panel (3) by pulling panel upwards and outward.

4

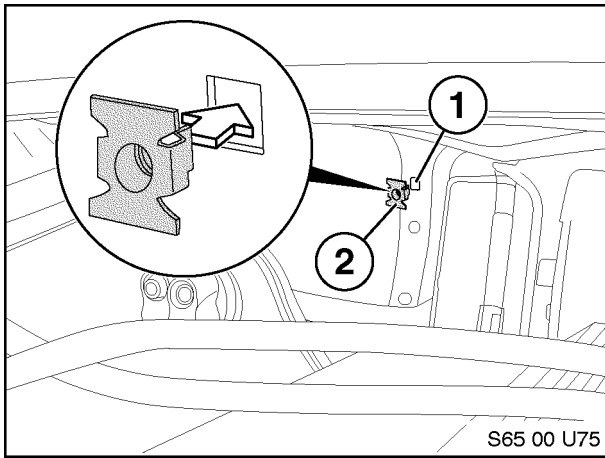

9. Look into the RH (passenger's side) area of firewall and locate square hole (1) as shown.
10. Insert cage clip nut (2) into square hole (1). Press firmly on cage clip nut until it is fully flush with mounting surface.

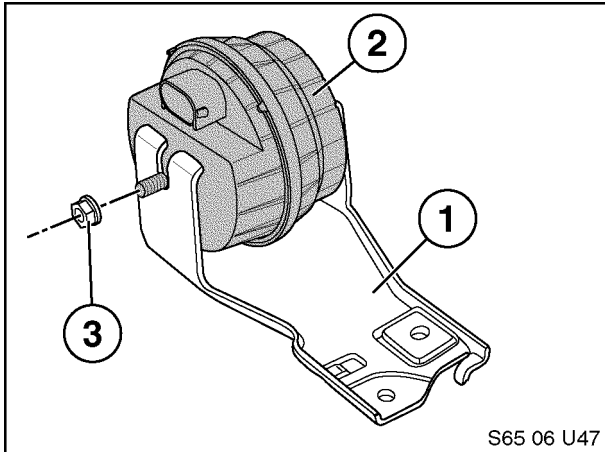

11. Assemble alarm siren-tilt-sensor (2) to mounting bracket (1) using M6 nut with captive flat washer (3) as shown.

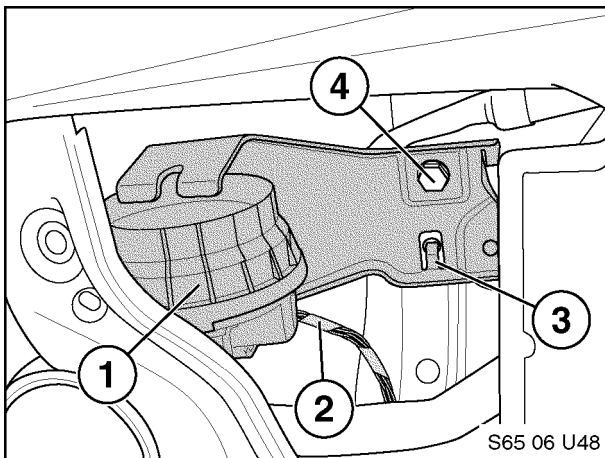

12. Locate (unwrap from wire harness) the 6-position alarm siren connector (2) and connect to alarm siren-tilt-sensor (1).
13. Position alarm siren -tilt-sensor/mounting bracket assembly into position utilizing the positioning tab (3) and secure assembly in place with M6x16mm bolt with captive flat washer (4) as shown.
14. Reassemble all displaced or previously removed items.

Installation Complete

Proceed to Interior Module installation.

Alarm Interior Module Installation

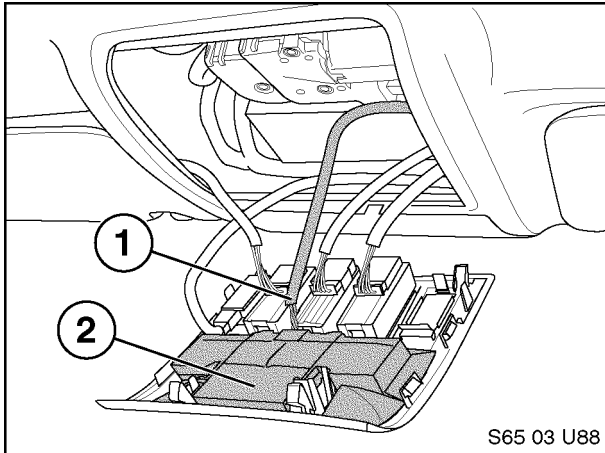
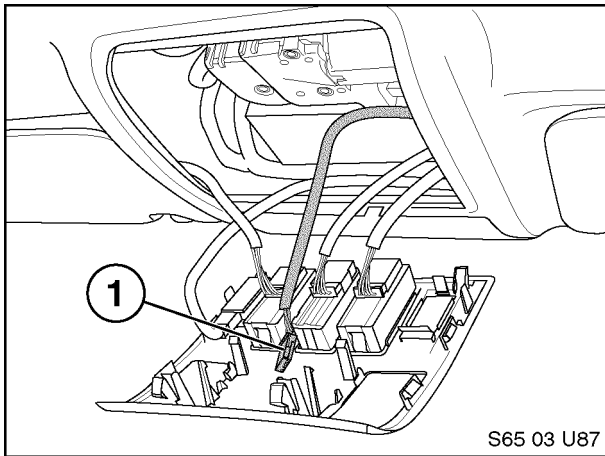

Note: Before proceeding make sure hands are clean to prevent soiling of headliner.

1. Dismount control panel from forward center of headliner with plastic trim removal tool.
2. Locate alarm interior module 4-position connector (1) found wrapped to wire harness above headliner.

3. Mount alarm interior module (2) to control panel and connect alarm interior module connector (1) to module as shown.

Remount control panel to headliner.

Installation Complete

Proceed to Retrofit Coding

RETROFIT CODING

Reconnect battery.

Note: Please refer to SI B09 05 01 for latest retrofit procedure before starting vehicle coding.

Retrofit Alarm using ISTA/P version 33.3 or later.

Follow approved ISTA/P Retrofit procedure:

- **Select:** "Vehicle" tab
- **Select:** "Conversions" tab
- **Select:** "DWA Alarm"
- **Select:** "Determine Measures Plan"
- **Select:** "Accept Measures Plan"

Upon completion of anti-theft alarm system coding, conduct alarm system test to verify functionality of alarm system. It may be necessary for the vehicle to complete a sleep cycle prior to testing functionality.